

CABINES DE TRANSMISSÃO  
Escala 1:100

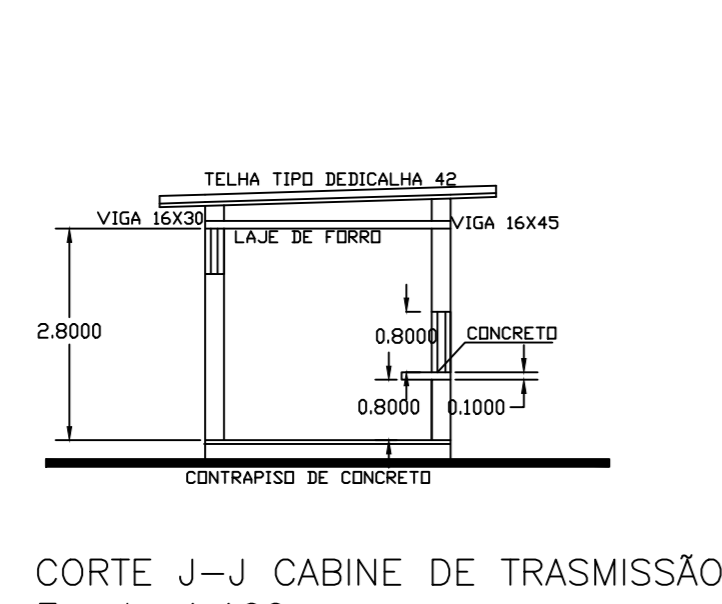

CORTE J-J CABINE DE TRANSMISSÃO  
Escala 1:100

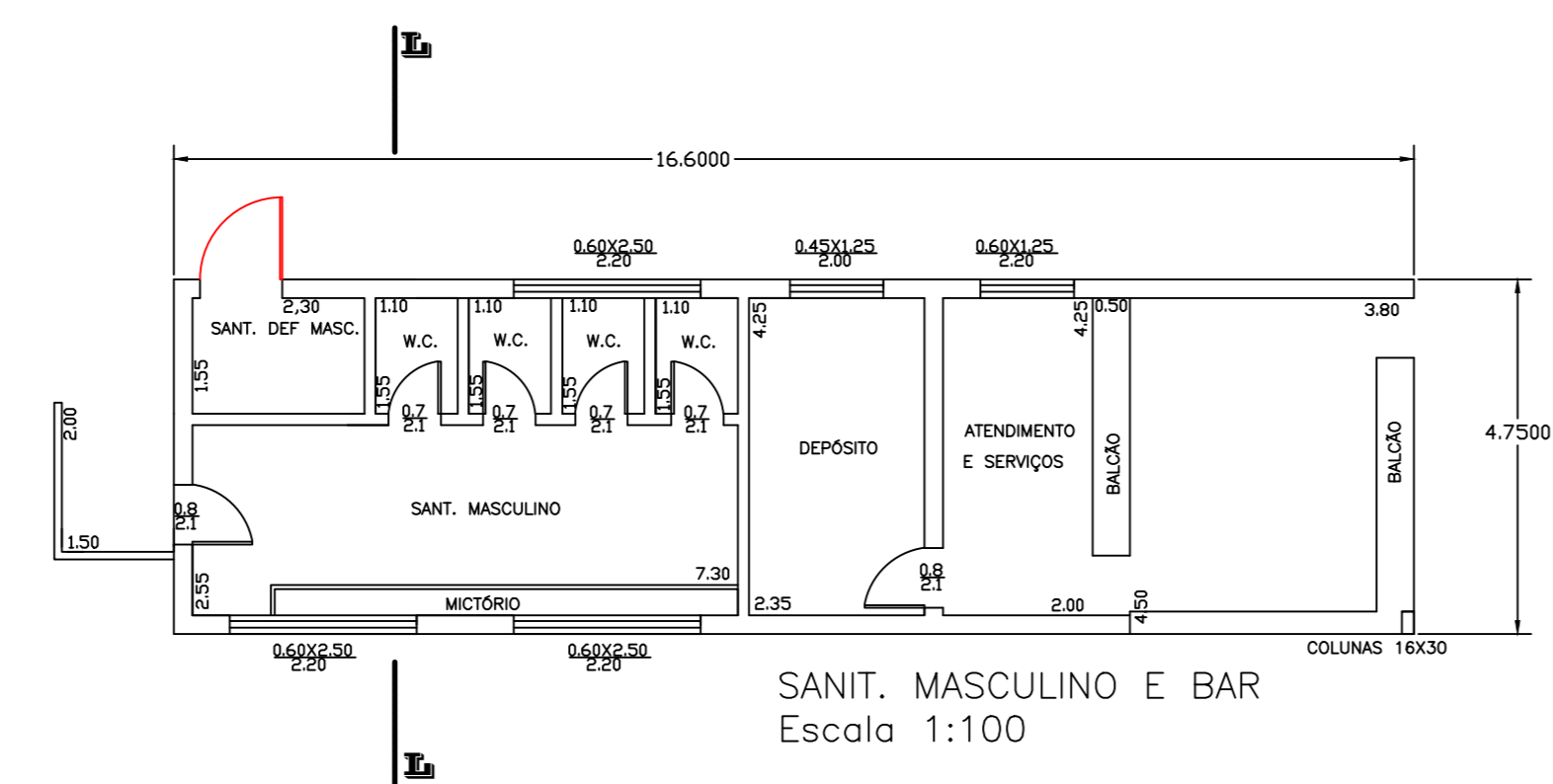

SANIT. MASCULINO E BAR  
Escala 1:100

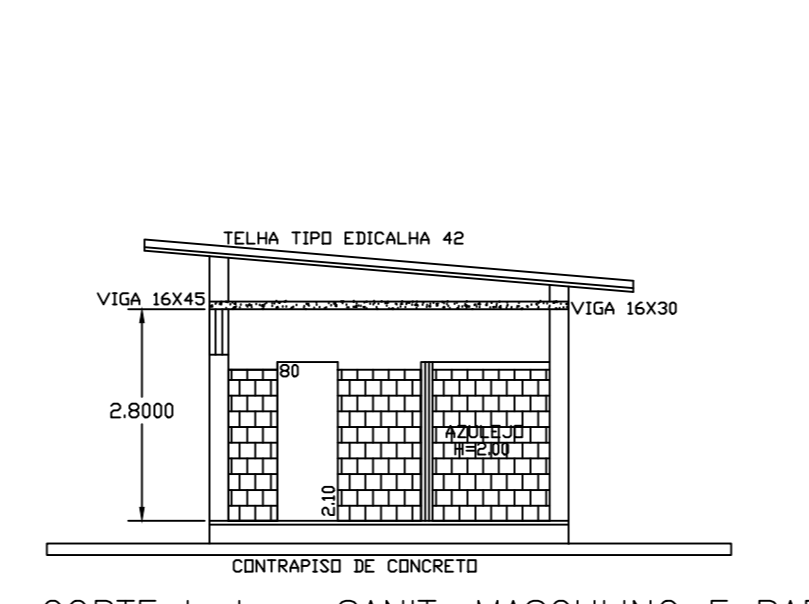

CORTE L-L - SANIT. MASCULINO E BAR  
Escala 1:100

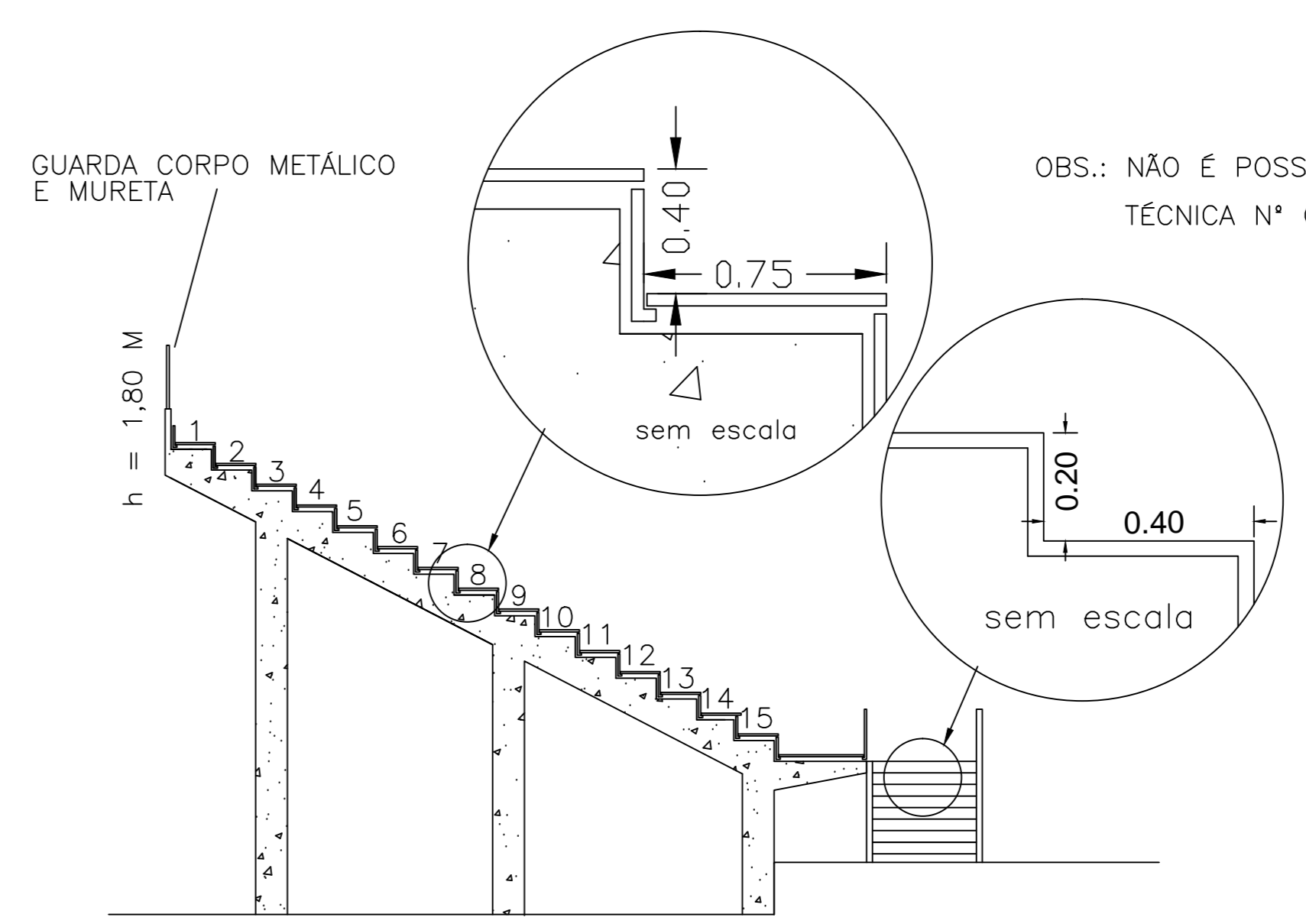

CORTE I - I ARQUIBANCADA 2  
1:100

OBS.: NÃO É POSSÍVEL ADEQUAR OS DEGRAUS DAS ESCADAS À INSTRUÇÃO TÉCNICA Nº CB-014/33.00, TENDO EM VISTA QUE A EDIFICAÇÃO É EXISTENTE.

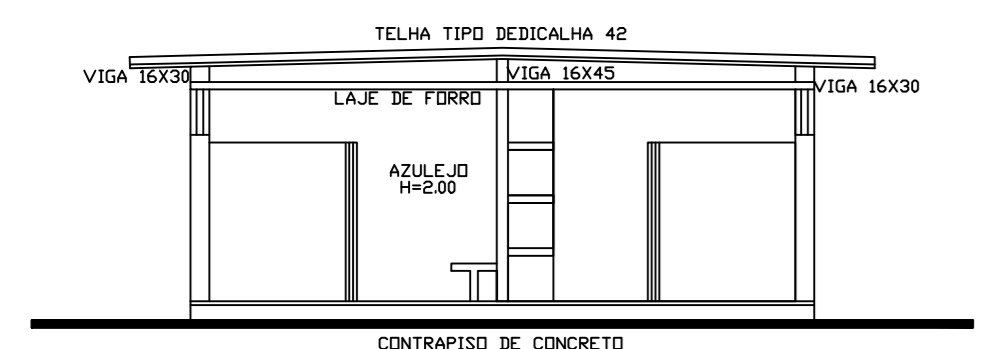
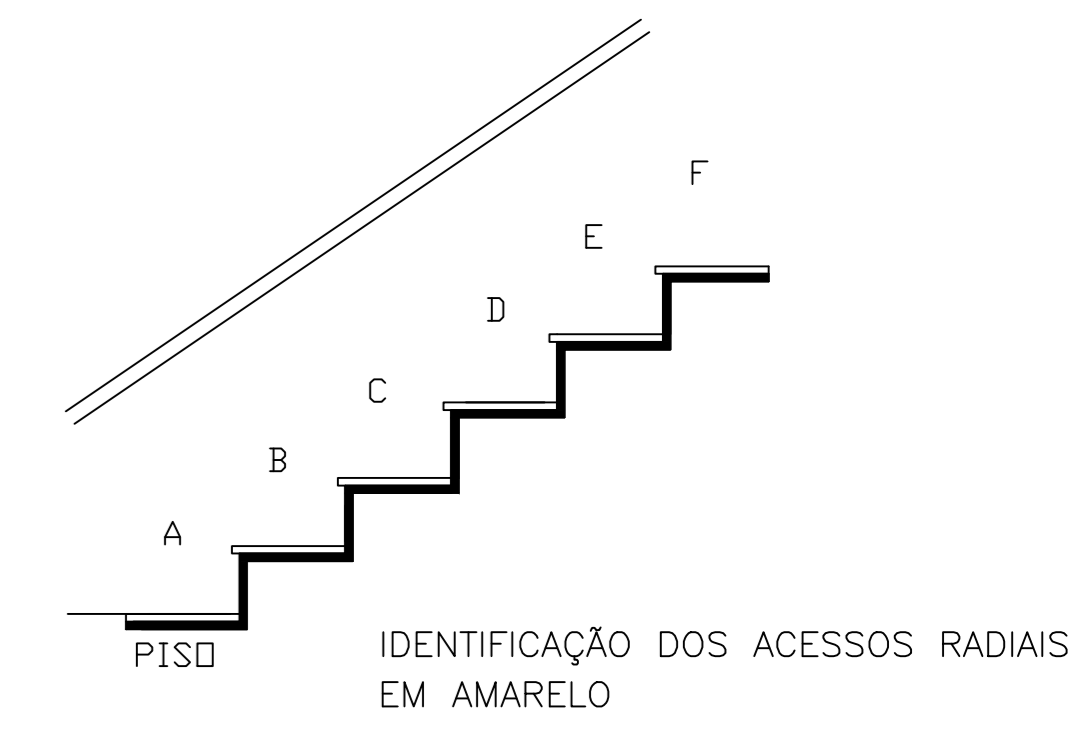

CORTE M-M - VESTIÁRIOS  
Escala 1:100

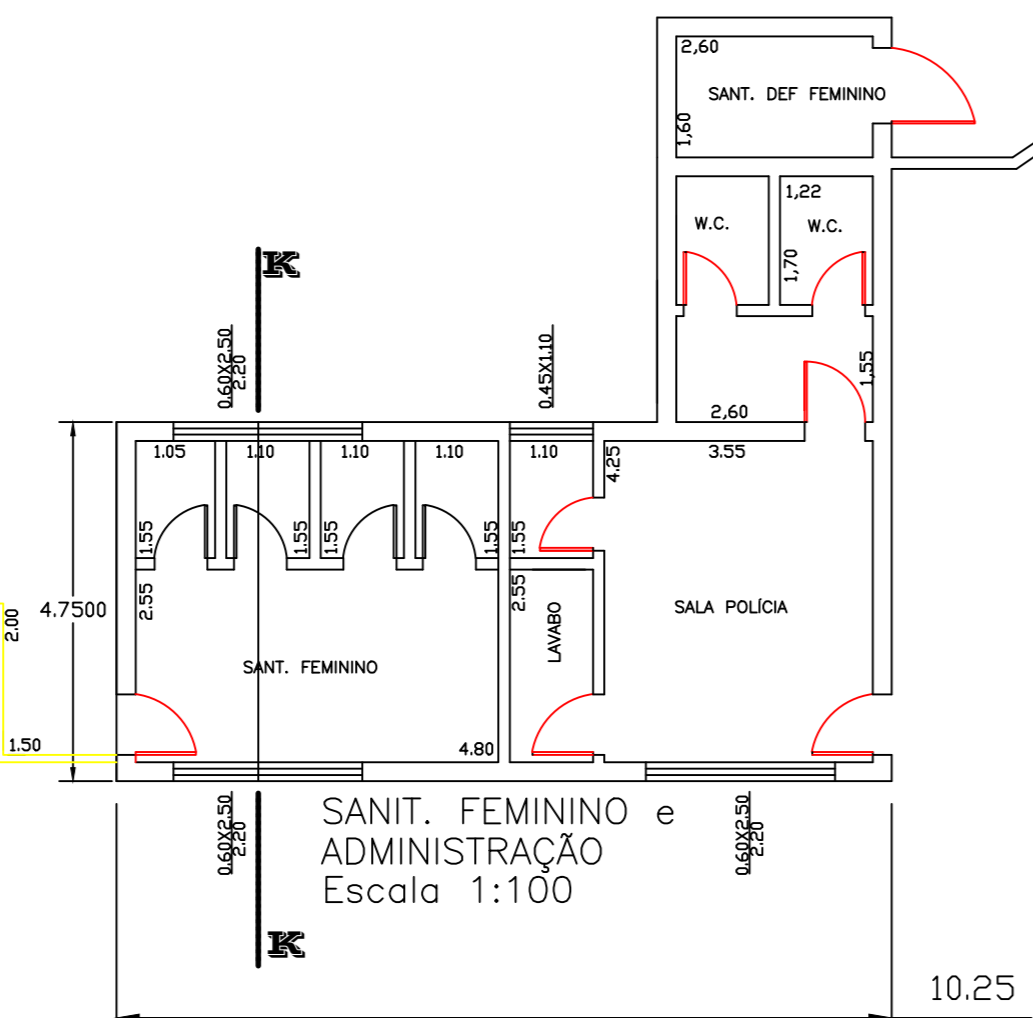

SANIT. FEMININO e ADMINISTRAÇÃO  
Escala 1:100

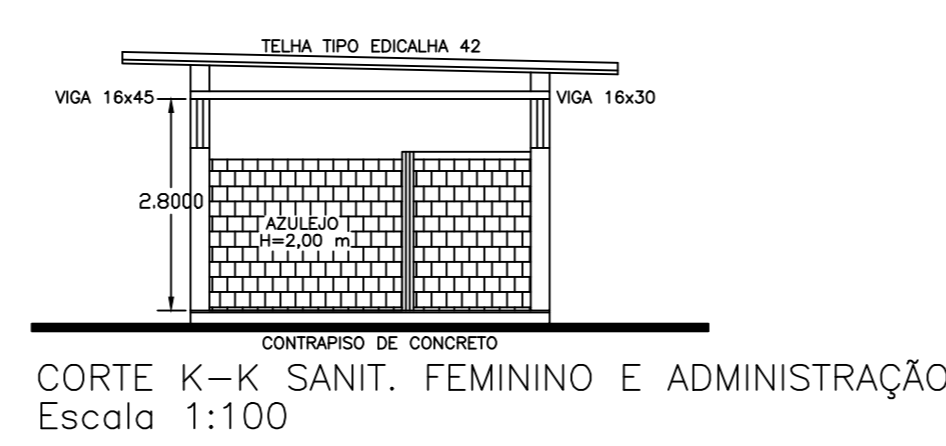

CORTE K-K SANIT. FEMININO E ADMINISTRAÇÃO  
Escala 1:100

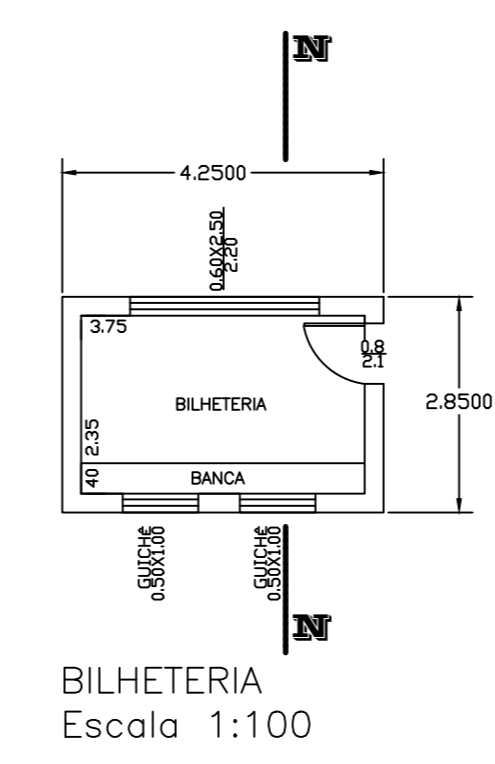

BILHETERIA  
Escala 1:100

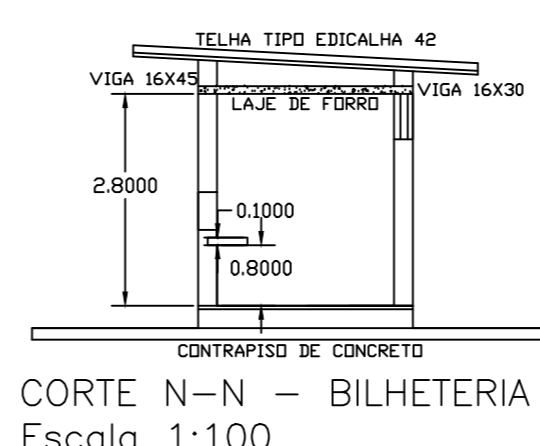

CORTE N-N - BILHETERIA  
Escala 1:100

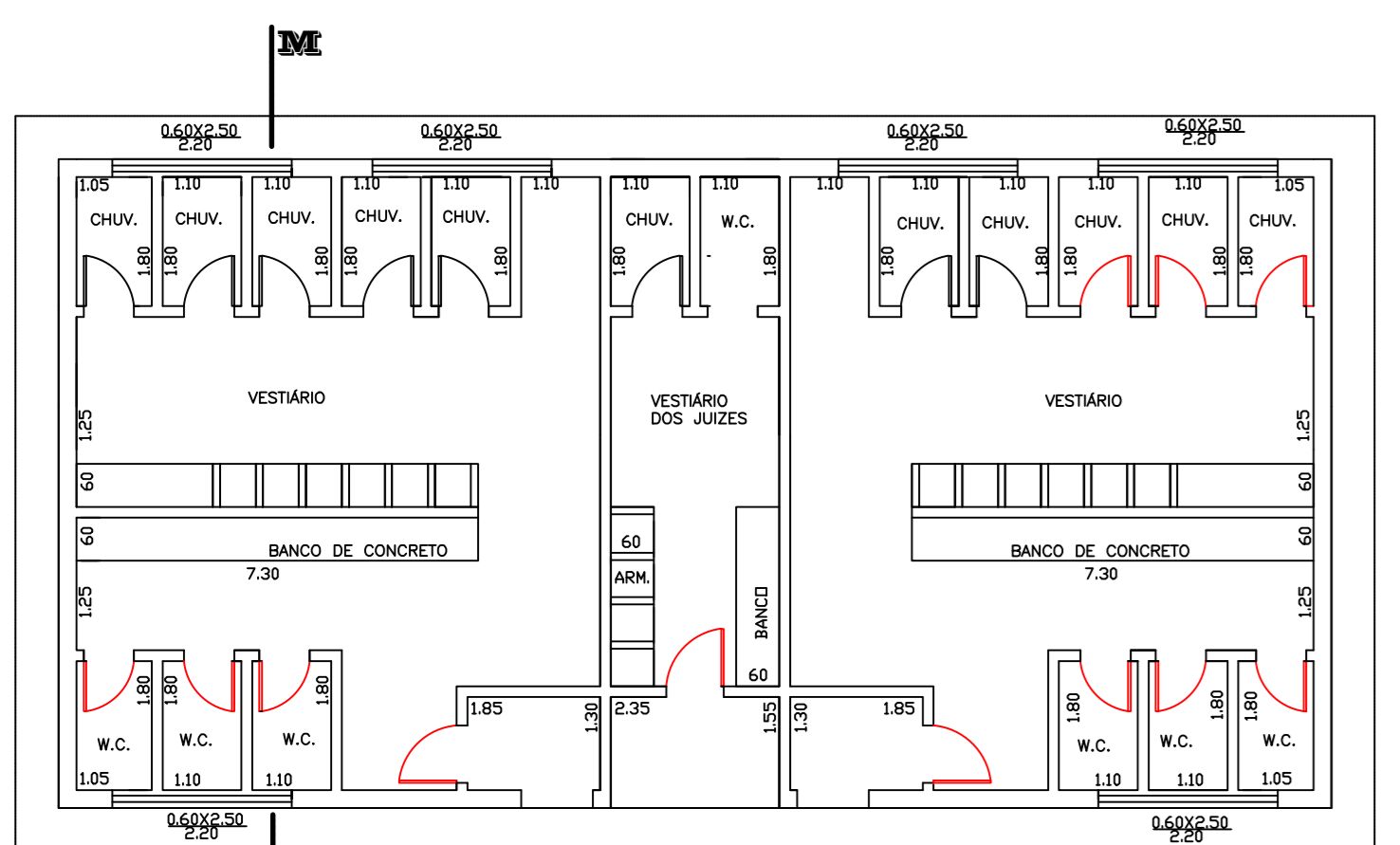

VESTIÁRIOS  
Escala 1:100

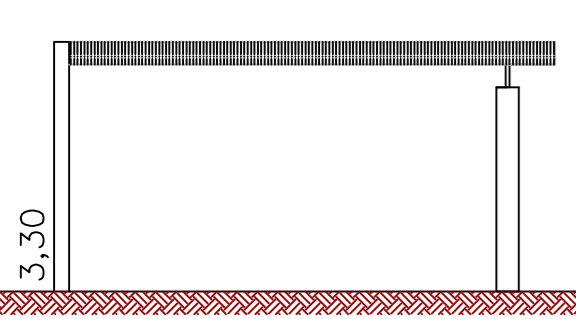

Corte D-D - ACESSO COBERTO  
Escala 1:100

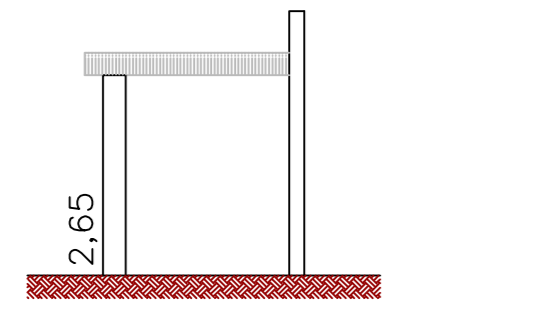

Corte C-C - ACESSO COBERTO  
Escala 1:100

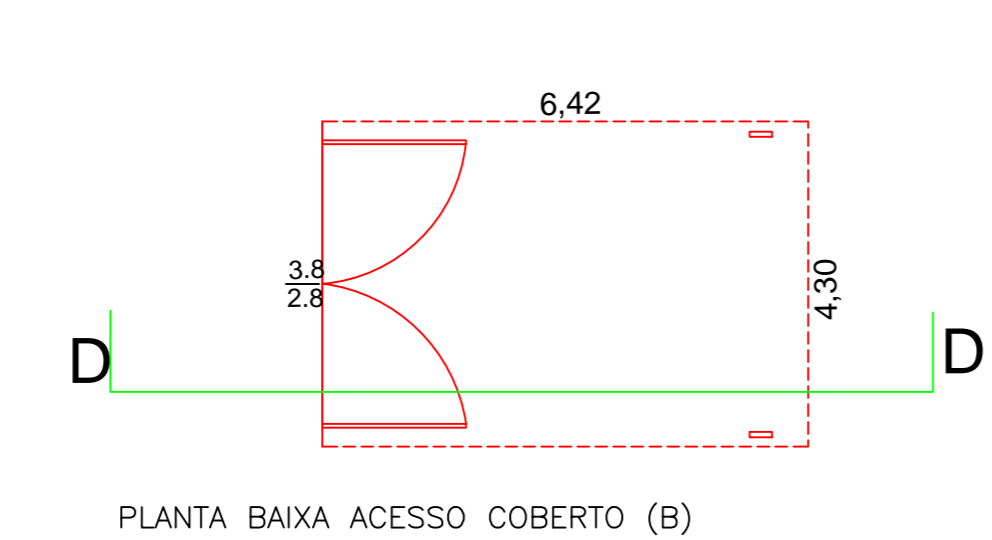

PLANTA BAIXA ACESSO COBERTO (B)  
Escala 1:100

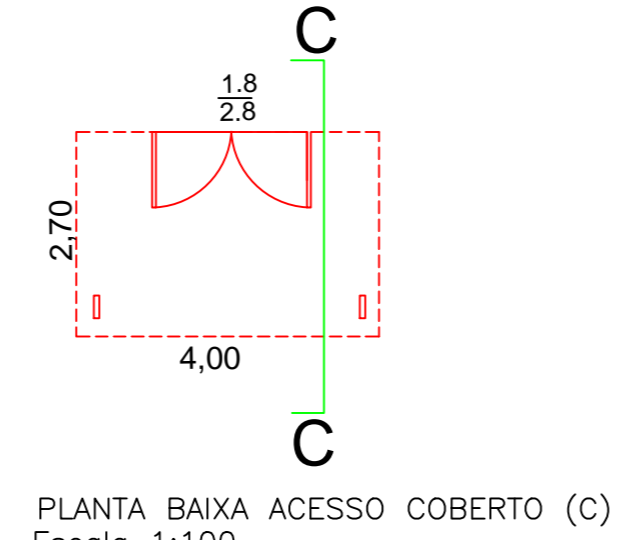

PLANTA BAIXA ACESSO COBERTO (C)  
Escala 1:100

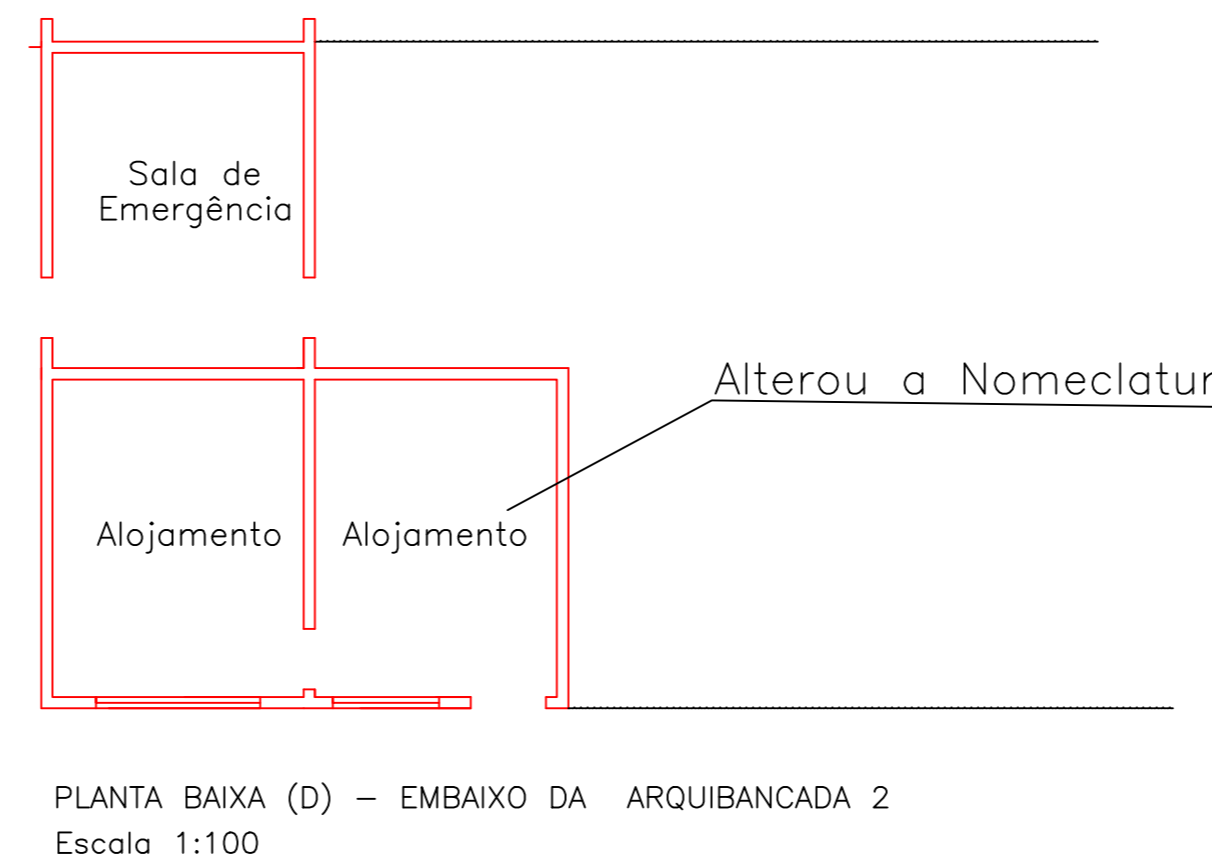

PLANTA BAIXA (D) - EMBAIXA DA ARQUIBANCADA 2  
Escala 1:100

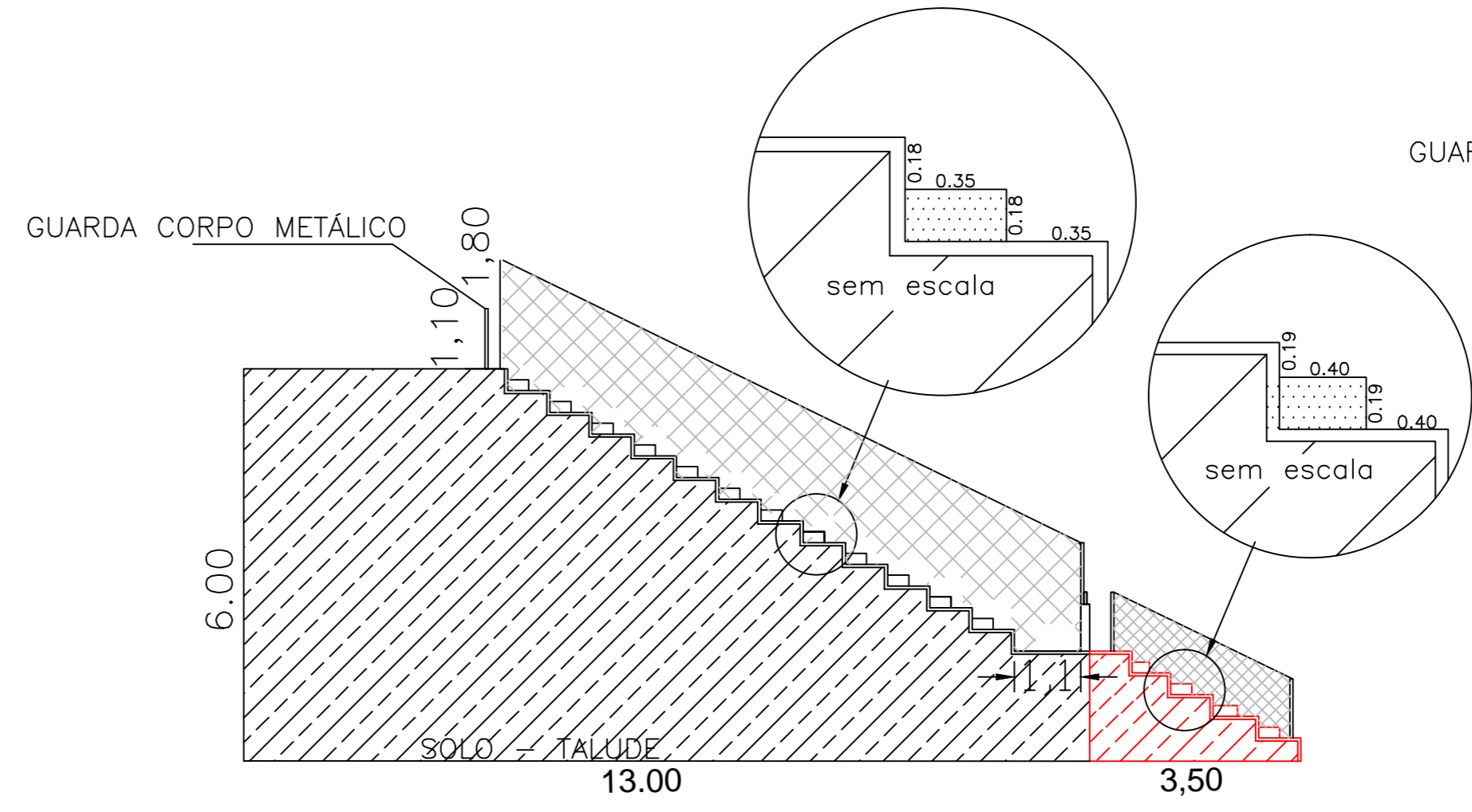

Corte E-E - ARQUIBANCADA 1  
Escala 1:100

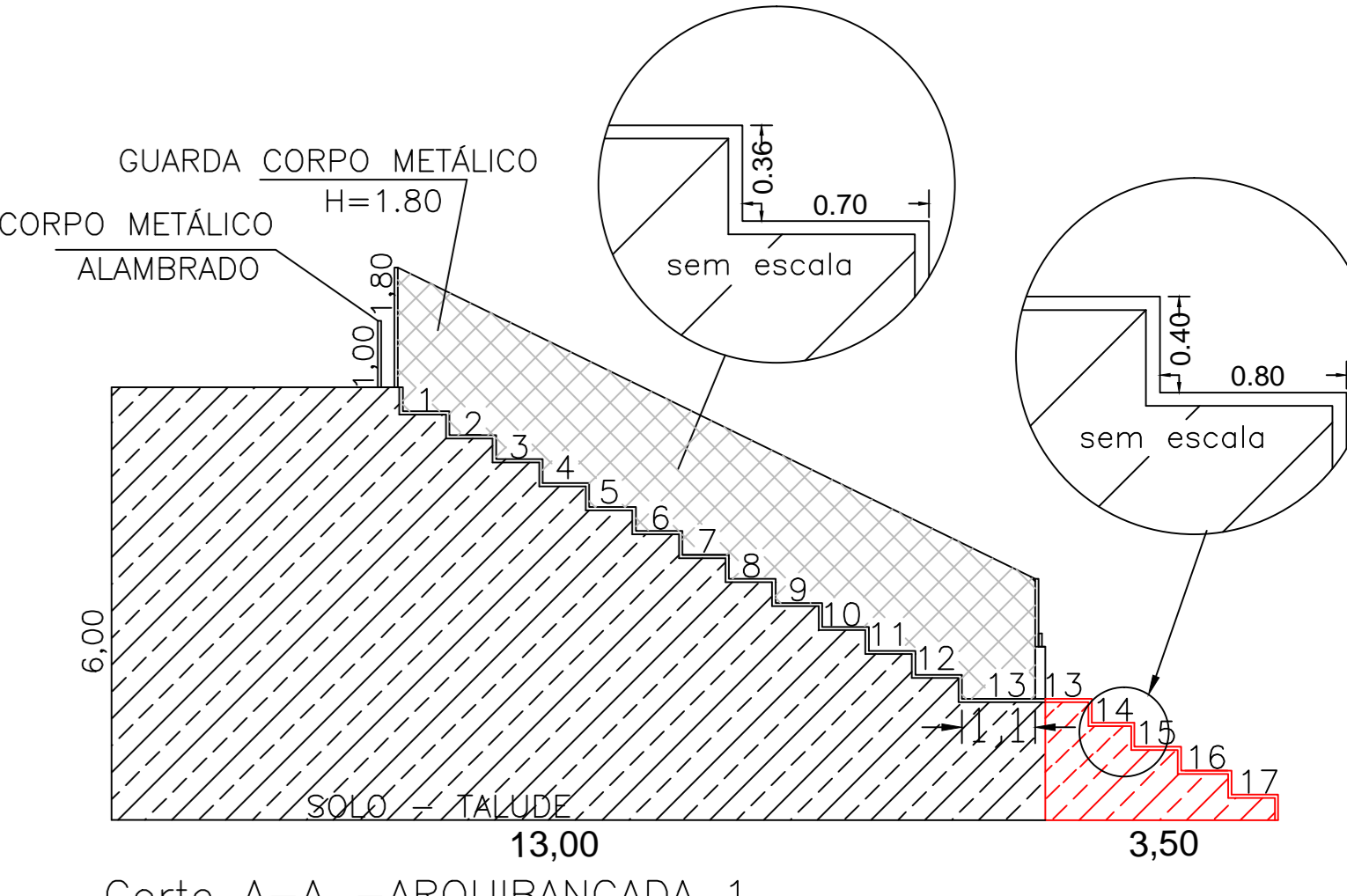

Corte A-A - ARQUIBANCADA 1  
Escala 1:100

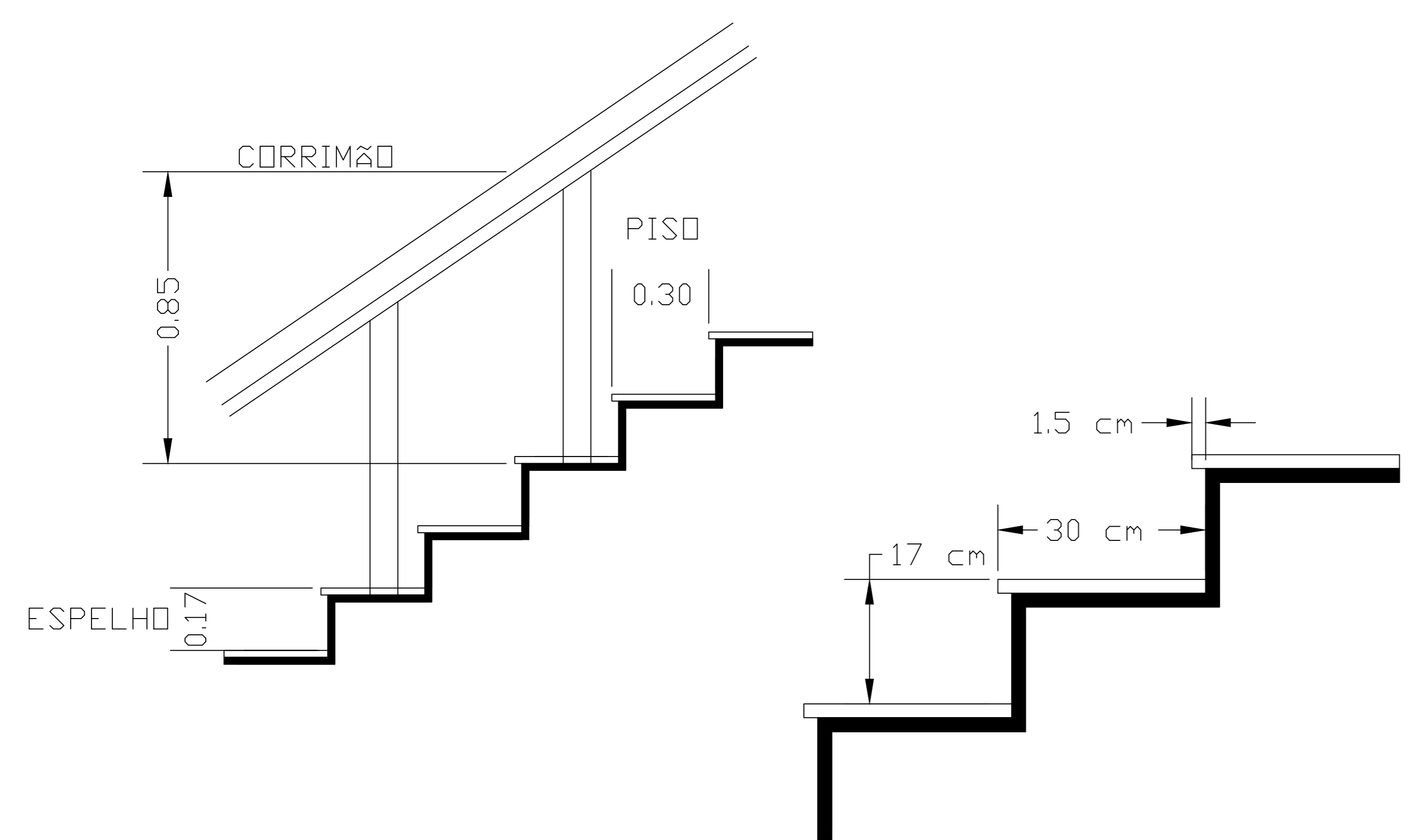

DETALHES DOS DEGRAUS DA ESCADA E ALTURA DOS CORRIMÃOS Sem Escala

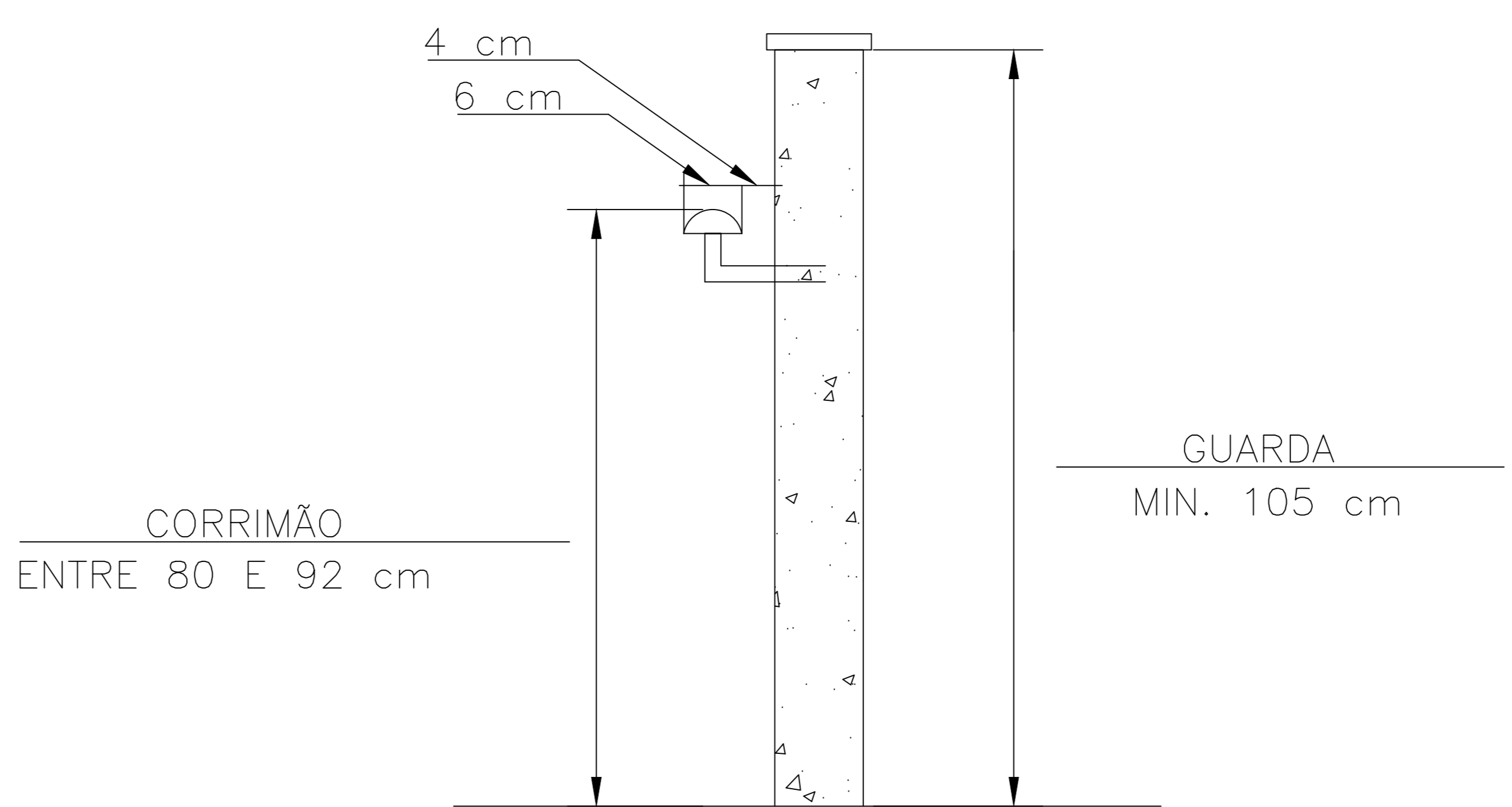

DETALHES DE FIXAÇÃO DOS CORRIMÃOS Sem Escala

PREFEITURA DO MUNICÍPIO DE LEME  
SECRETARIA DE OBRAS E PLANEJAMENTO URBANO  
FOLHA 03  
ASSUNTO: REFORMA E ADEQUAÇÃO DO ESTÁDIO MUNICIPAL "BRUNO LAZZARINI"  
LOCAL: AV. JOSÉ ANTONIO PERCEM N. 20 VILA SÃO ADÃO LEME - SP  
ÁREAS: TERRENO 36.290,56 m² CONSTRUÇÃO 18.824,78 m²  
PROJETO: 28027230180388329  
DATA: 08/2018  
ESCALAS: INDICADAS  
FERNANDO CARLOS BERGAMIN ENGENHEIRO CIVIL CRESP 500.186/18  
FERNANDO WAGNER KLEIN SECRETÁRIO DE OBRAS E PLANEJAMENTO URBANO  
WAGNER RICARDO ANTUNES FILHO PREFEITO MUNICIPAL